

Gas-tight hinged door

BSL-3

BSL-4

The door system made of ground stainless steel can be produced individually adapted to the installation situation. The hinged door either opens to the right or left and is therefore suitable for all room constellations. The tightness of the door

system is achieved by means of a mechanically pressed seal. The door system meets the requirements for tightness up to biosafety level 4 according to Canadian biosafety guidelines.

Dimensions

Clear frame width (=A)	700 - 1400 mm
Frame outer dimension	closed frame: A +180 mm corner frame: A + 280 mm
Clear inner width	A - 20 mm (lever handle projection at 90° opening angle: 115 mm)
Clear frame height	2000 - 2400 mm
Wall thickness (=B)	125 - 350 mm
Door leaf width	A + 32 mm

Frame

Material	ground stainless steel, Mat. no. 1.4301, ground with grain size 240
Frame type	closed frame for system wall or plasterboard wall corner frame for masonry or concrete wall
Ground sill	flat drive-over threshold: 7 mm (with floor recess) high threshold: min. 20 mm (with or without floor recess)

Door leaf

Construction	sandwich construction approx. 41 mm
Surface	ground stainless steel (Mat. no. 1.4301)
Door hinges	3 x two-dimensionally adjustable stainless steel hinges
Door handles	lever handles on both sides central locking lever on both sides with 3-way locking

Sealing system

Sealing system	removable surrounding seal made of silicone profile
Tightness	± 500 Pa with a maximum pressure drop of ± 250 Pa within 20 min according to Canadian biosafety guideline
Noise insulation rate (DIN 4109)	Rw: 45 dB

Special fittings

Locking system	bolt locking in the door frame integrated Schmersal locking system in the door leaf
Signals	"locking status" feedback contact "door status" feedback contact (up to three independent door status messages possible)
Drive	full automation by means of automated locking in combination with a swing door operator
Inspection window	rectangular: 400 x 600 mm 600 x 600 mm 400 x 1500 mm round: Ø 400 mm (without blinds)
Window accessories	red light filter for animal husbandry 100% darkening
Door leaf core	water resistant waterproof
Material	ground stainless steel (Mat. no. 1.4404)
Fire protection	EI30 EI60
Control components	request button emergency open red-green LED display (as wall-mounted or wall-recessed variant next to the door)
Data transfer	separate terminal box for transfer of control signals up to 5 m away from the door

Gas-tight hinged door

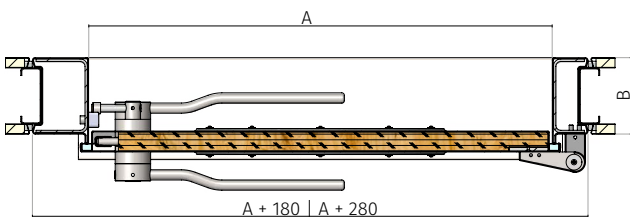
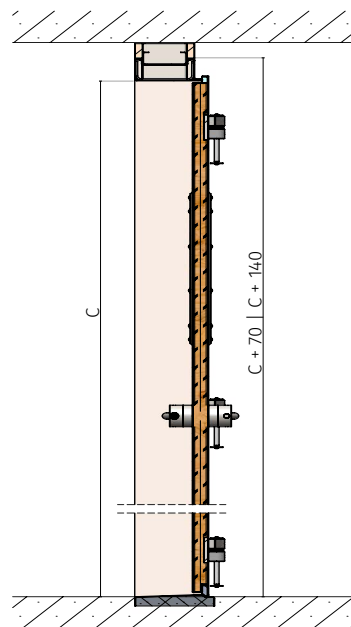
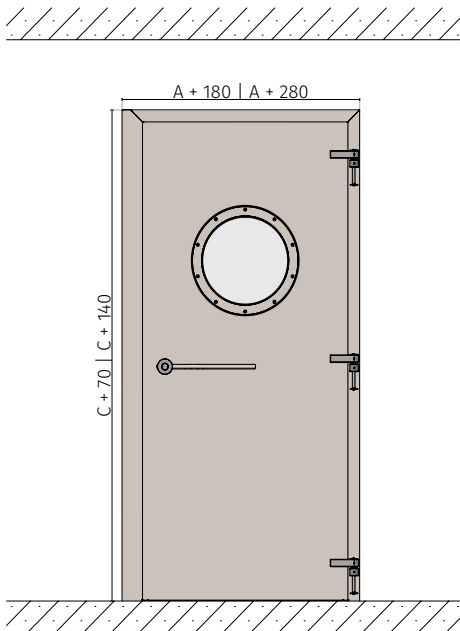

low threshold

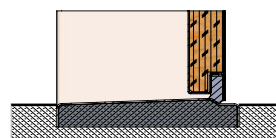

high threshold

